

thermo
Sphere

HEATING | WALL
TOWEL BARS

ThermoSphere 12V SE Towel
Bar Installation Guide



Warranty terms & conditions

ThermoSphere covers all its products with a satisfaction guarantee. In addition, ThermoSphere will supply a replacement product where a fault is shown to be caused by manufacture, materials or workmanship providing the goods have been installed correctly and according to installation instructions. This guarantee does not include removal, freight or installation costs.

To use the warranty, repair or service the customer must provide purchase invoice/receipt, and completed warranty registration form.

If the product develops a fault within the warranty period due to normal wear and tear, ThermoSphere at its discretion will recognise whether it's a faulty product or not. If it is impossible or not economical for the manufacturer to repair the product, the manufacturer will replace the faulty product with a new unit of the same model or if there is no stock available of the same model as the product, the manufacturer will replace the product with a new unit of a similar size. No responsibility can be taken for altered dimensions and lining up of existing holes.

The repair service offered within the warranty period only covers the faults and problems as developed from the manufacturer's errors. Any damage caused by improper use or carelessness or incorrect wiring is not covered.

ThermoSphere is not responsible for any monetary loss or injuries caused by improper use or installation of this product.

Please Note: Full Terms and Conditions are available on request.

Email hello@thermosphere.com to request your copy or give us a call.

Safety and care information

ThermoSphere Towel Bars should be connected to the electrical supply by a qualified electrician and in accordance with current local regulations.

We recommend that the towel bar is installed with the bottom bar at least 600mm from the floor and with a 300mm clearance from permanent fixtures.

Recommended spacing between bars is 150mm

ThermoSphere Heated Towel Bars can be fixed onto timber stud, steel stud or masonry (solid or cavity) walls.

Stud walls require noggins at the correct position for all fixings and if the exact position cannot be determined early in the job, we recommend using noggins covered with 18mm construction ply or OSB covering a larger area.

Fixing to plasterboard or cement sheeting alone is not recommended and will not hold long term.

ThermoSphere SE Towel Bars are designed to be installed BEFORE TILING and as such it is imperative that the fixing spigot and/or mounting system is installed perfectly level. We recommend using a laser level and checking the level periodically throughout installation.

Towel bars are 12V SELV (safety extra low voltage) and can be installed in bathrooms.

Ensure any controls used are installed in correct zone according to the IP rating of the control

Ensure that your towel bar is protected by a suitably rated RCD

Do not use the towel bar to hold towels or other articles that have been in contact with oil, petroleum based products or dry cleaning fluids

This appliance is intended to warm and dry towels not heat spaces

Do not immerse your towel bar in liquid

Ensure the transformer is located no further than 2m from the ThermoSphere Towel Bar

Ensure the transformer is accessible and has adequate ventilation

Care information

The Stainless Steel finish of your towel bar is hard wearing and easy to maintain. However any harsh scrubbing, scratching or acid based cleaning products will damage the surface of your towel rail.

Clean with a soft cloth dampened with warm and warm soapy water only. Dry immediately for the best finish.

Max weight warning

ThermoSphere SE Towel bars are designed to hold towels only, and must not be subjected to excessive forces over 10kg and must not be climbed on or used as support rails.

This can result in injury and can cause damage to the towel bars which is not covered under the guarantee.

Contents

What's in the box?	4
Key considerations	5
Single bar installation	6
Multiple bar installation	9
Example wall build up	13
Wiring schematics	14
Available models	15

Watch the installation videos!



Single SE Bar installation
without mounting system



Multiple SE Bar installation
with mounting system

What's in the box?

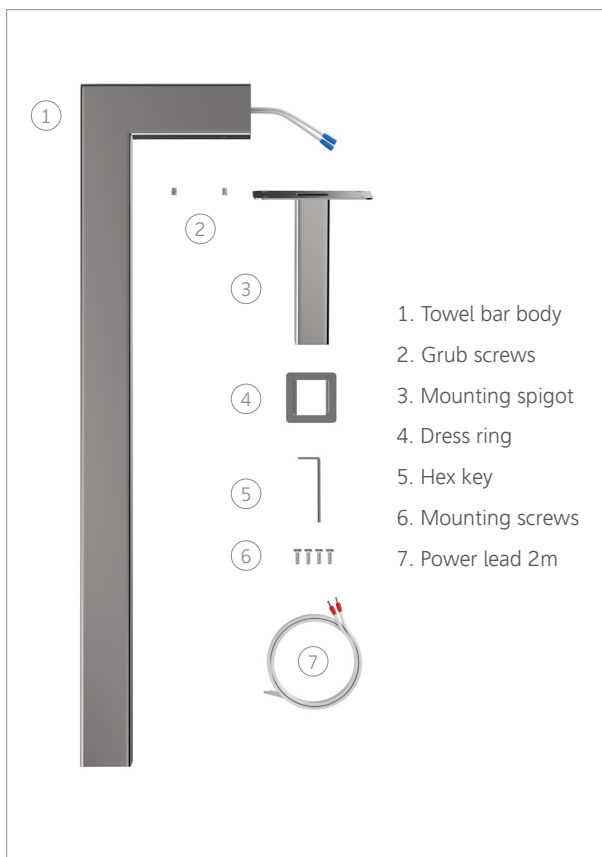

You will also need

- Fixings that are suitable for your wall substrate
- Laser level or spirit level
- Cordless drill or impact driver
- Marker pen or pencil
- 30mm diamond hole cutter bit
- 25mm timber hole cutter bit
- Suitable rated 12V transformer
- 230V electrical supply
- Fibreglass mesh tape

Key considerations

Fixing spigots must be installed before tiling!

SE Towel Bars fixing spigots are designed for installation before tiling. You must install the fixings spigots and run cables before you tile the wall. There is no option to install SE Towel Bars on top of a tiled wall.

You MUST make sure fixing spigots are level!

Because the fixing spigots are installed behind the tiles, you have to take extra care to make sure they are installed level. We recommend using a laser level throughout the process to check the towel bars are nice and level!

Use the right fixings for your wall substrate

We recommend that you fix SE Towel Bars to a solid wall, such as a brick/block cavity wall, a secure timber noggin within a cavity wall or a plywood/OSB panel. Use fixings that are suitable for the type of wall you are fixing to. We do not recommend fixing directly to plasterboard or tile backer boards as this can cause the fixings to move over time and result in loose towel bars.

Low voltage transformers

SE Towel Bars are 12V DC and there is no polarity. You must install a suitably rated 12V transformer between the towel bar and the 230V supply. You can connect multiple towel bars to one transformer in parallel, up to the maximum load of the transformer. The transformer should be somewhere accessible to facilitate replacement.

Max tiling depth is 28mm

The maximum depth of the tiled wall layers that will be situated over the fixing spigot is **28mm**. This includes any boards, tile adhesive and the tiles. Limiting the tiling depth ensures that there is enough spigot protruding from the wall to achieve a good, strong fixing to the towel bar.

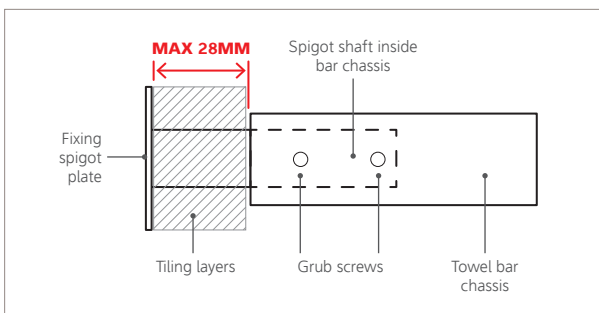

Installing single bars

(No mounting system)

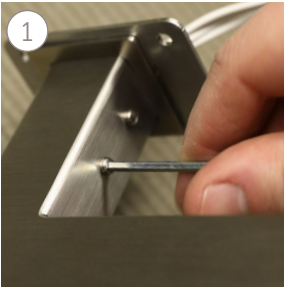

1
Loosen the grub screws with a hex key.

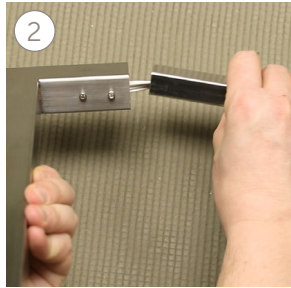

2
Remove the spigot and dress ring and keep safe to one side.

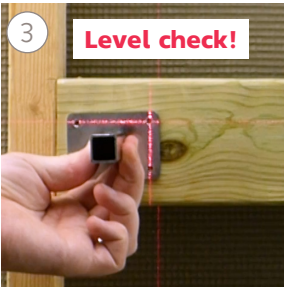

3
Level check!
Ensure the spigot is level and mark fixing holes. A laser level is recommended.

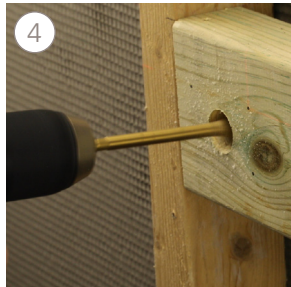

4
Drill a hole in the noggin big enough to pass the connection cables through (22-25mm).

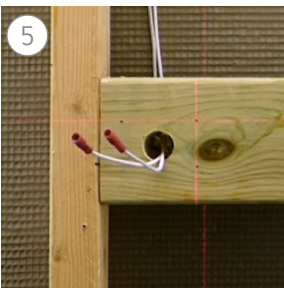

5
Feed the connection cables through the hole and up to a 12V transformer.



6
Pull the connection cables through the spigot and a screw in the top right corner.

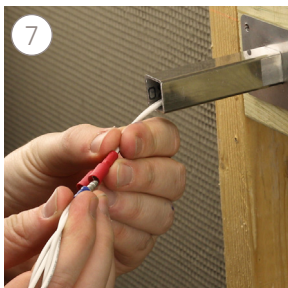

Plug in the red and blue bullet connectors and push excess cable through the noggin.

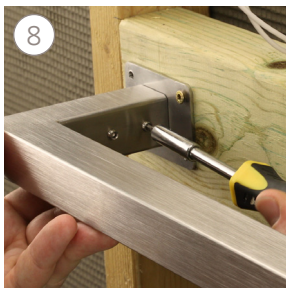

Reinstate the towel bar and tighten the grub screws with a hex key.

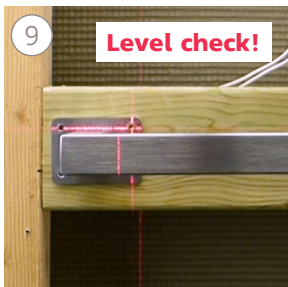

Adjust the level of the towel bar using a laser level and hold in position.



Fix a screw into the bottom left hole of the mounting plate and check the level again.



Only when you're happy with the level, fit the remaining fixing screws.



Cut a 22mm hole in the wall board that is going over the spigot. Secure with screws and washers.



13 **Max tiling depth 28mm**

Cut a 30mm hole in the tile that is situated over the mounting spigot and tile the wall as normal.



14

Once tile adhesive has dried, place the dress ring over the spigot and fit the towel bar.

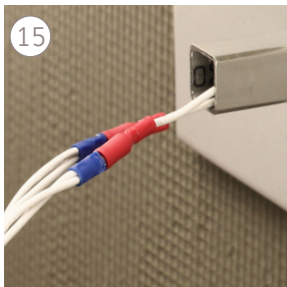

15

Plug in the red and blue bullet connectors (**12V no polarity**) and feed excess cable into the wall cavity.

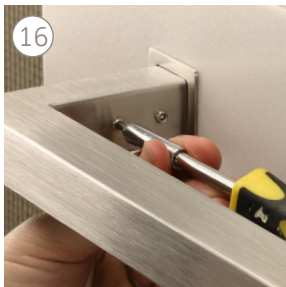

16

Fit the towel bar, locate the dress ring and tighten the grub screws.

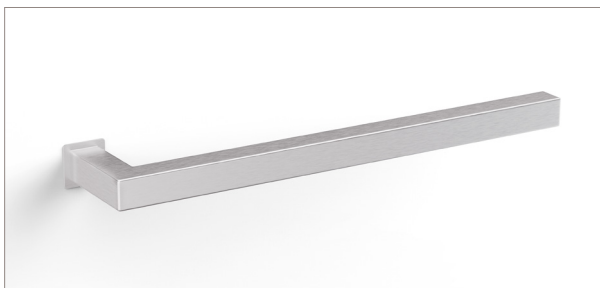

And you're done!

Installing multiple bars

(With a mounting system)

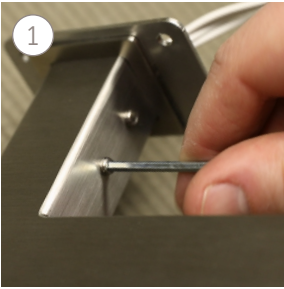

1
Loosen the grub screws with the hex key.

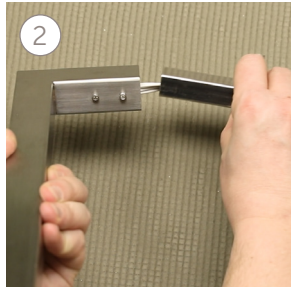

2
Remove the spigot and dress ring and keep safe to one side.

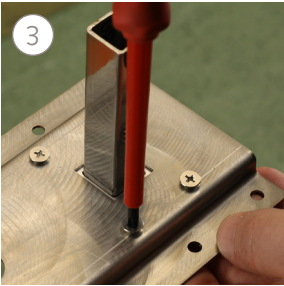

3
Pass each spigot through the back of the mounting system and fix tightly with 4x10mm fixing screws.

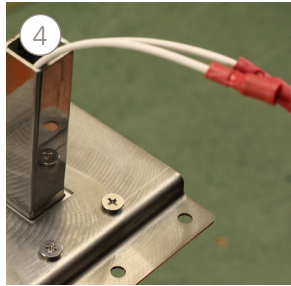

4
Feed a connection cable through each spigot leaving at least 80mm of cable to work with

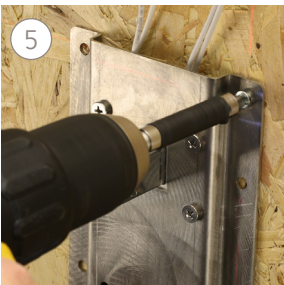

5
Fix a screw into the top right corner and pull cables up to the 12V transformer before fixing the mounting system in position.

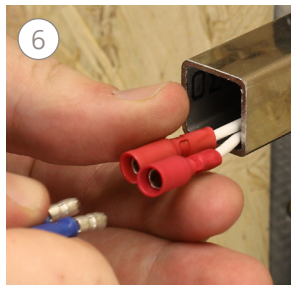

6
Plug in the red and blue bullet connectors and feed any excess cable behind the mounting system.



7
Position the towel bar over the spigot taking care not to pinch the cables. Tighten the grub screws with a hex key.



8 **Level check!**
Make sure the towel bars are level before proceeding. Only when you are happy with the level, secure the bottom left fixing screw

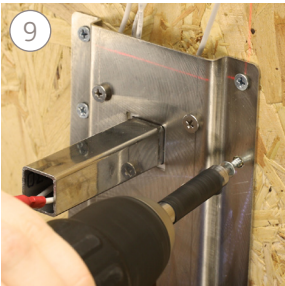

9
Now remove the towel bar, unplug the connection cables and secure the mounting system to the wall with suitable screws.

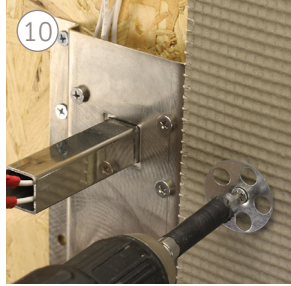

10
Fix tile backer/insulation boards to the wall flush with the front of the mounting system. Follow the board manufacturer guidelines.



11
Drill a hole and feed the connection cables through the wall cavity to a 12V transformer. Do not drill the cables!

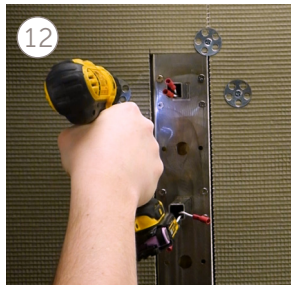

12
Cut a tile backer board to fit around the mounting system and fix with screws and washers. Make the wall ready for tiling.

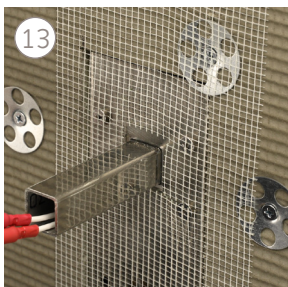

13
Cover the mounting system with mesh joint tape to make tiling easier

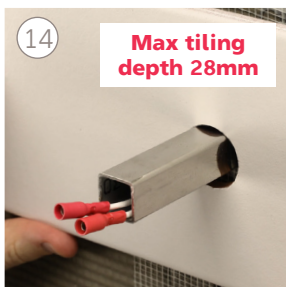

14
Max tiling depth 28mm
Cut a 30mm hole in the tile that is situated over the mounting spigot. Use tile adhesive to tile the wall as normal.



15
Once tile adhesive has dried you can fit the towel bar. Place the dress ring over the spigot.

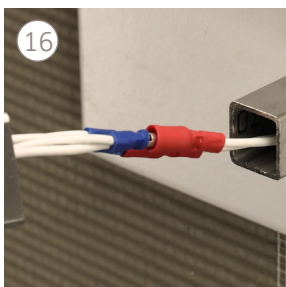

16
Plug in the red and blue bullet connectors (**12V no polarity**) and feed any excess cable through the noggin into the wall cavity.

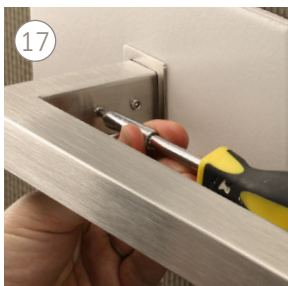

17
Position each towel bar over the spigot taking care not to pinch the cables, locate the dress ring and tighten the grub screws.

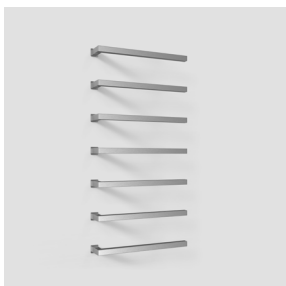

You can install up to 7 SE Towel Bars on one mounting system. The mounting system makes aligning and levelling multiple bars quick and easy.

Example wall build up

The image below shows how a full wall build up looks with a mounting system, tile baker boards, tiling and dress rings.



IMPORTANT! The thickness of all layers that are installed over the fixing spigot mounting plate must not exceed 35mm.

In this example the wall build up is 20mm and includes the mounting system (2mm), adhesive (6mm) and tile (12mm).

If you don't leave enough spigot protruding from the wall, you won't be able to secure the towel bars properly!

Cable management

The mounting system makes cable management easy. You can run the cables behind the mounting system and drill a hole at the top to pass them into the cavity and up to your wiring point

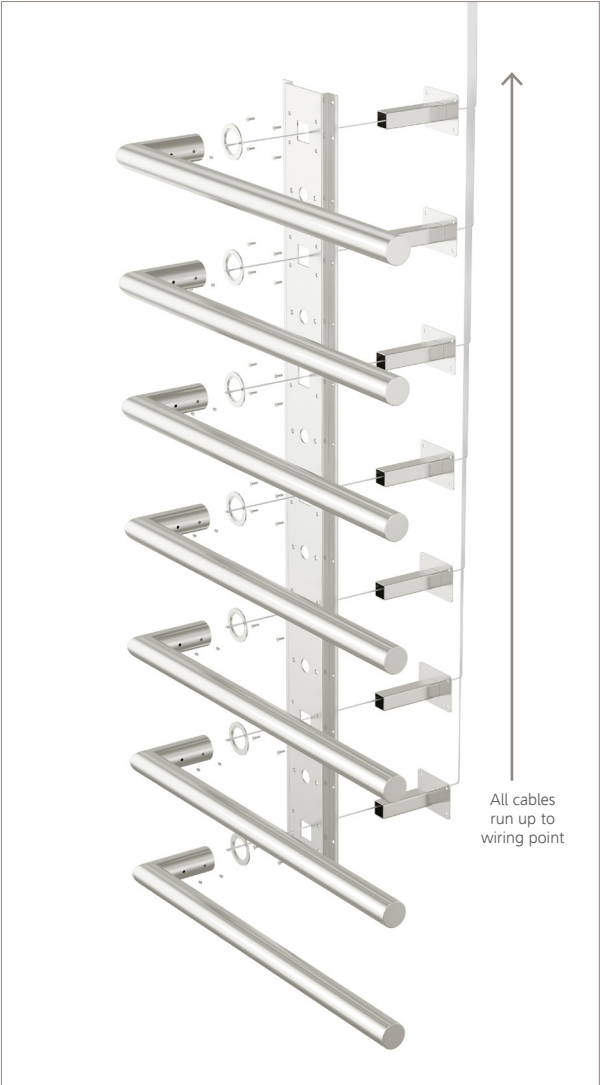

If you're installing on a solid brick/block wall you will need to chase a channel for the cables.

Alternatively, you can use the multiple mounting systems to run the cables behind and cover the wall with a backer board before installing tiles. This avoids the need to chase cable channels.

Wiring schematics

All electrical work must be compliant with the relevant local regulations and carried out by a professional electrician. Isolate the electrical supply before you start.

Single towel bars

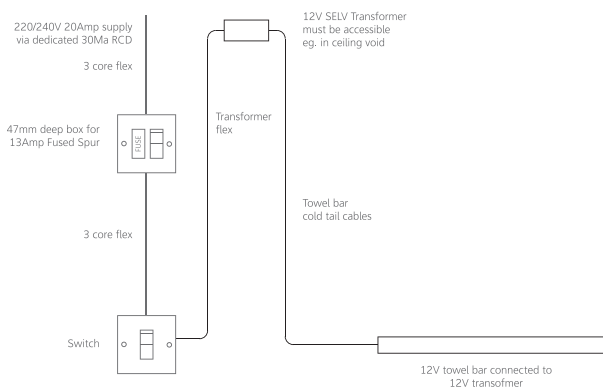

Multiple towel bars

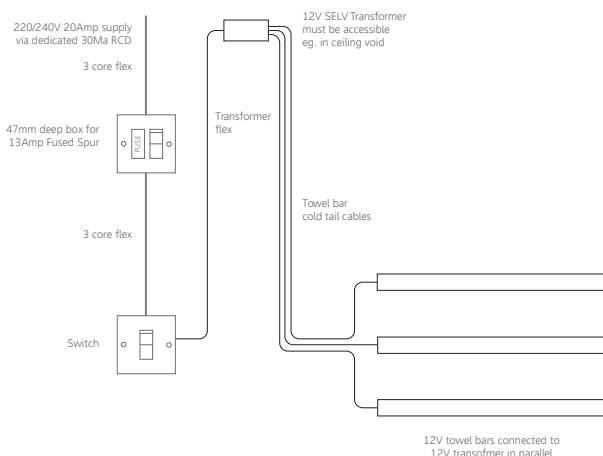

ThermoSphere SE Towel Bars are 12V SELV and can be installed safely anywhere in a bathroom. All electrical circuits in bathrooms must be protected by a suitably rated RCD.

Available models

Round profile

SKU	Finish	Size	Output (W)
HTB-SRS-500	Diamond polished	500 x 32 x 32	25
HTB-SRS-500-BSS	Brushed stainless steel	500 x 32 x 32	25
HTB-SRS-500-PLB	Polished brass	500 x 32 x 32	25
HTB-SRS-500-BRB	Brushed brass	500 x 32 x 32	25
HTB-SRS-500-MBK	Matt black	500 x 32 x 32	25
HTB-SRS-500-MWT	Matt white	500 x 32 x 32	25

Square profile

SKU	Finish	Size	Output
HTB-SSS-500	Diamond polished	500 x 30 x 30	25
HTB-SSS-500-BSS	Brushed stainless steel	500 x 30 x 30	25
HTB-SSS-500-PLB	Polished brass	500 x 30 x 30	25
HTB-SSS-500-BRB	Brushed brass	500 x 30 x 30	25
HTB-SSS-500-MBK	Matt black	500 x 30 x 30	25
HTB-SSS-500-MWT	Matt white	500 x 30 x 30	25

**Thermogroup Ltd
T/A ThermoSphere**

Bridge House
Pattenden Lane
Marden
Kent
TN12 9QJ
UNITED KINGDOM

www.thermosphere.com
hello@thermosphere.com
+44 (0) 800 019 5899

